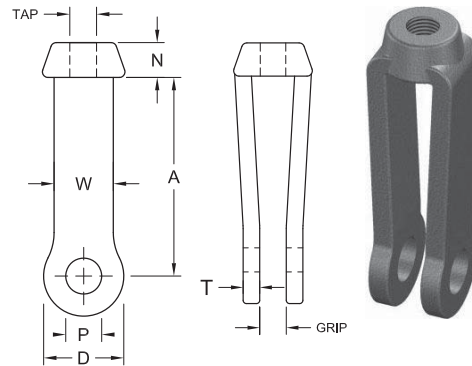



FIG. 735

Forged Steel Clevis

SERVICE: For use on high temperature piping installations.
MATERIAL: Carbon Steel
FINISH: Black or Hot-Dip Galvanized
STANDARDS: MSS SP-58 Type 14, FS WW-H-171E Type 14
ORDERING: Specify figure number, size, rod tapping size, pin hole size, pin size (if required), grip size and finish.



ROD SIZE (TAP)	GRIP	BODY SIZE	A	D	T	N	W	PIN SIZE P	WEIGHT EACH, LBS.	MAX. REC. LOAD, LBS. 650°F
3/8	1/2	#2	3 ⁹ / ₁₆	1 ⁷ / ₁₆	5/16	5/8	1 ¹ / ₁₆	1/2	1.7	610
1/2	5/8							1130		
5/8	3/4							1810		
3/4	3/4	#2.5	4	2 ¹ / ₂	5/16	1	1 ¹ / ₄	7/8	2.5	2710
7/8	1							3770		
1	1	#3	5 ¹ / ₁₆	3	1/2	1 ¹ / ₄	1 ¹ / ₂	1 ¹ / ₈	4.0	4960
1 ¹ / ₈	1 ¹ / ₈							6230		
1 ¹ / ₄	1 ¹ / ₄							8000		
1 ¹ / ₂	1 ¹ / ₂	#3.5	6	3 ¹ / ₂	1/2	1 ¹ / ₂	1 ³ / ₄	1 ⁵ / ₈	6.0	11630