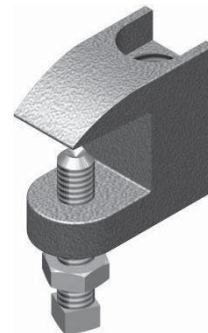



**FIG. 636**

**Junior Top Beam Clamp, Domestic**

- SERVICE:** For attaching hanger rod to top or bottom of flange of a beam or bar joist where thickness does not exceed 3/4".
- MATERIAL:** Malleable Iron casting
- FINISH:** Electro-Galvanized
- STANDARDS:** MSS SP-58 Type 19 & 23
- APPROVALS:** FM NFPA, UL for top & bottom of Beam
- ORDERING:** Specify figure number, rod size and finish. (Furnished with a hardened cup point set screw and lock nut.)



| ROD SIZE<br>A | B     | C     | D   | E     | F     | WEIGHT<br>EACH, LBS. | MAX. REC.<br>LOAD, LBS. |
|---------------|-------|-------|-----|-------|-------|----------------------|-------------------------|
| 1/2           | 1     | 1 1/2 | 1/2 | 1     | 7/8   | 0.39                 | 500                     |
| 5/8           | 1 1/2 | 1 1/2 | 1/2 | 1     | 1     | 0.58                 | 600                     |
| 3/4           | 1 7/8 | 1 3/4 | 5/8 | 1 3/8 | 1 1/4 | 0.82                 | 800                     |
| 7/8           | 2     | 1 3/4 | 5/8 | 1 1/2 | 1 1/4 | 0.79                 | 1200                    |

