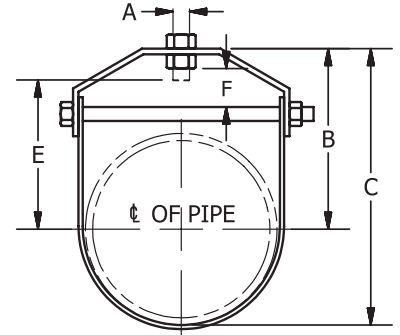



FIG. 200

Adjustable Clevis Hanger

- SERVICE:** For the suspension of non-insulated, stationary piping services.
- MATERIAL:** Carbon Steel (ASTM A36) or Stainless Steel (ASTM A240, Types 304 and 316)
- FINISH:** Electro-Galvanized (ASTM B633) or Hot-Dip Galvanized (ASTM A123)
- STANDARDS:** MSS SP-58 Type 1, FS WW-H-171E Type 1
- APPROVALS:** FM (NPS 3/4" - 4" galv), UL & ULC (NPS 2 1/2" - 8" excluding 7")
- ORDERING:** Specify figure number, pipe size, material and finish. (Clevis Hangers for 20" pipe and larger are furnished with a cross rod spacer.)



PIPE SIZE	A	B	C	E	F	BOLT	WEIGHT EACH, LBS.	MAX. REC. LOAD, LBS.
1/2	3/8	1 11/16	2 1/16	5/16	7/16	1/4	0.18	730
3/4	3/8	1 11/16	2 9/16	1 5/16	7/16	1/4	0.20	730
1	3/8	2 1/16	2 11/16	1 1/4	5/8	1/4	0.22	730
1 1/4	3/8	2 1/2	3 3/16	1 11/16	7/8	1/4	0.26	730
1 1/2	3/8	2 7/8	3 11/16	2 1/16	1 1/16	1/4	0.32	730
2	3/8	3 5/16	4 7/16	2 1/2	1 1/4	1/4	0.41	730
2 1/2	1/2	4 1/2	5 7/8	3 3/8	1 15/16	5/16	0.84	1130
3	1/2	4 3/4	6 1/2	3 11/16	1 3/4	5/16	0.94	1130
3 1/2	1/2	5 7/8	7 15/16	4 13/16	2 9/16	5/16	1.19	1350
4	5/8	5 15/16	8 3/16	4 9/16	2 1/8	3/8	1.32	1430
5	5/8	5 11/16	8 7/16	4 5/16	1 7/16	1/2	2.11	1430
6	3/4	6 13/16	10 1/8	5 3/16	1 3/4	1/2	2.96	1940
7	3/4	7 13/16	11 5/8	6 3/16	2	1/2	3.24	2000
8	3/4	8 1/16	12 7/16	6 1/4	1 7/8	5/8	4.53	2000
10	7/8	10	15 7/16	8	2 1/4	3/4	8.23	3600
12	7/8	11 9/16	18	9 9/16	2 13/16	3/4	10.35	3800
14	1	12 9/16	19 9/16	10 9/16	2 9/16	7/8	14.37	4200
16	1	14 3/16	22 3/16	11 15/16	2 15/16	1	20.56	4600
18	1	16 1/16	25 1/16	13 7/8	3 15/16	1	23.07	4800
20	1 1/4	17 5/8	27 5/8	15 1/8	3 3/4	1 1/4	47.13	4800
24	1 1/4	19 7/16	31 7/16	17 3/8	3 3/4	1 1/4	54.00	4800
30	1 1/4	24 9/16	39 9/16	21 1/2	5 3/8	1 1/4	69.00	6000
36	1 1/4	29 13/16	47 13/16	27 1/16	6 7/8	1 1/4	168.00	6000